



## Company Profile



# 1 Who we are

## ► A global piping solutions provider with:

- Technical expertise
- Multiple stock locations
- Supply chain management
- Value-added services

## ► 130 years of ambition

- Started in 1881 in France as an industrial supply store.

## ► Unique engagement

- A trustworthy relationship
- Operational peace of mind
- Best technical solutions
- Competitive Total Cost of Ownership



Upstream



Midstream



Downstream

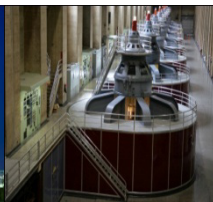

Power



Chemical



Construction



Water



Biodiesel



Geothermal



- Process & Line Pipes



- Instrumentation



- Valves & Actuators



- Structural steel



- Piping for Building & Infrastructure



- Steam & Condensate products



- Steel for PV, Boiler & Tanks



# 1 | Where we are

Our international team, which spans the globe from Seoul to Houston, stands ready to meet your global requirements with a local approach.





## 2 What we believe

### ➤ Unique vision

Only a piping specialist with unique capabilities and knowledge can meet the piping system requirements of today.

### ➤ Unique point of contact :

- With professionals able to understand your project piping requirements.
- Who provide optimum technical solutions.
- With regional stock support.
- Through a logistic platform for on-time deliveries.
- Dedicated after-sales support.
- To experience a lifelong customer – vendor relationship.

### ➤ Unique offering

- Major oil & gas, energy, industrial, construction and infrastructure projects
- Combination of the best materials, high-capacity stock and logistics, value-added services, and the fairest prices.







## 3 Markets



## ► Our customers

Main players of the entire project cycle: end-users, EPCs, fabricators, and maintenance contractors.

### DOWNSTREAM

- Petrochemical
- Refining



### MIDSTREAM

- Pipeline
- Terminal
- Storage tank



### UPSTREAM

- Mining
- Drilling
- Offshore Production facilities
- Onshore Production
- Facilities



### ENERGY, PROCESS INDUSTRIES & CONSTRUCTION

- Power
- Chemical
- Water
- Biodiesel
- Building
- Infrastructure
- Geothermal

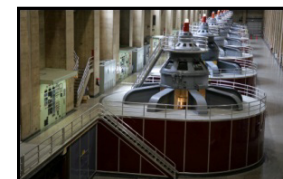



## 4 Products

## ► Piping Division

- Carbon Steel Seamless & Welded pipes & tubes
- Carbon Steel SAW Pipes
- Stainless Steel Pipes & Tubes
- Coated Pipes
- Pipe Grooving Systems
- Ductile Iron Drainage Systems for Building
- Piping Accessories



## ► Valve & Instrumentation Division

- Valves
- Actuator (Electronic, Pneumatic, Hydrolink)
- Steam Products
- Instrumentation products (pressure/temperature)
- Valve Automation Center
- Dedicated Services





## ► Steam & Hot Water Engineering Division

- Steam Products
- Hot water boilers
- Steam boilers
- Calorifiers
- Heat exchangers
- Solar Systems
- Heat Pumps
- Control Panels
- Design
- Engineering
- Installation
- Maintenance
- Services



## Piping Division



Carbon Steel Pipes



LNG train – Ras Laffan - Qatar



Saadiyat Island - Abu Dhabi - UAE

## ► CS Seamless & HF-ERW Pipes & Tubes

- CS Seamless Pipes & tubes from OD 1/4" to 24", with Wall Thickness up to 59,54mm.

**Specification:** API 5L (44RD Edition), PSL-1 & PSL-2, GR B, X-42 up to X-80, ASTM/ASME A106 GR B, A53 GR B, A333 GR 3/GR 6, API 2B, BS, DIN

- Alloy Seamless Pipes from OD 2" to 26"

**Specification:** A335 GR P5/P9/P11/P12/P91/P92

- Tubing with OD 25.4mm up to OD 141.3 with W.T. Max up to 15mm

**Specification:** A179

**CS Seamless pipes up to 24" is available ex-stock in our facilities**



## **CS Welded Pipes**

- **LSAW – From OD 16” to 275” with Wall Thickness up to 130mm**

**Specification:** API 5L (44th EDITION) PSL 1 & PSL2, GR B / X42 UPTO X100

A671 / A672 (ALL CLASSES )

A691 (Mo – Alloyed / Cr –Mo Alloyed / Ni- Alloyed / Mo-Ni Alloyed)

- **CS HF –ERW Pipes from OD 2” TO 26” with Wall thickness up to 18mm**

**Specification:** API 5L (44th EDITION) PSL 1 & PSL2, GR B / A53

- **HSAW – from OD 16” TO 120”, Max WT up to 25.4 MM**

**Specification:** API 5L (44th EDITION) PSL 1 & PSL2, GR B / X42 UPTO X100

**CS Welded pipes up to 48” is available ex-stock in our facilities**

## ► SS Pipes & Tubes

- Stainless Steel (300 Series), Duplex, Super Duplex Stainless Steel, Nickel Alloy and Metallurgically clad pipes from OD 3" to 80" ( welded ) with W.T up to 63mm ( with one or two longitudinal seam / multiple circular welds)
- Seamless Stainless pipes from OD 1/8" to 16" with W.T up to SCH XXS and up to 24" OD in SCH 10S, SCH 20S, SCH 40S.

**Specifications:** A312 /A358 CLS 1,2,3,4,5 / ASTM A790 / ASTM A928 CLS 1,2,3,4,5 / ASTM 775 / 904L

- Tubing with OD 25.4MM up to OD 141.3 with W.T max up to 4.6 MM.

**Specification:** A213 / A269

## ▶ Coated Pipes

- 3 Layer PE Coated
- External FBE Coated
- Internal Epoxy Coated
- External Coal Tar Enamel Coated
- Internal Cement Mortar Lined
- External cement Mortar Coated

## ▶ Pipe Grooving System

- SHURJOINT Painted Grooved Couplings & Fittings for Fire Protection & HVAC Pipeline
- SHURJOINT Galvanized Grooved Valves for Fire Protection & HVAC Pipeline
- SHURJOINT Stainless Steel & Copper Couplings and Fittings for Potable Water Pipelines
- SHURJOINT Threaded Fittings for small diameter Pipework
- SHURJOINT Ring Joint shouldered couplings for diameters up to 96"



**The material is currently available ex-stock  
from our facilities**



## ▶ **Cast Iron Drainage Systems**

- SAINT GOBAIN Cast Iron Pipes & Fittings for
  - ✓ Above ground Rainwater Drainage, Soil, Waste & Vent Piping
  - ✓ Below ground Rainwater Drainage, Soil, Waste & Vent Piping

**The material is currently available ex-stock  
from our facilities**

## ▶ **Piping Accessories**

- ELBOWS 45°, 90°, 180°
- Induction Bends
- Tees – Straight, Reducing, Concentric & Eccentric
- Flanges
- Gaskets
- Nuts & Bolts

## Valve & Instrumentation Division



## ▶ Valves can be supplied...

- ....in any material, grade, standard
  - ✓ Cast Iron, Ductile Iron (GGG40, etc...)
  - ✓ Carbon Steel (ASTM A105, LF2, A216 WCB, WCC, LCB, LCC etc...)
  - ✓ Alloy Steel (ASTM A217 WC6 / WC9 / C12A, A182 F11 / F22 / F91, AISI 4130 / 410 etc...)
  - ✓ Stainless Steel (A351 CF8 / CF3/ CF8M / CF3M / CF8C, A182 F304 / F304L / F316 / F316L / F321 / F347 / F44 / F904L etc...)
  - ✓ Duplex / Super Duplex / Special Alloy
  
- ... With any required connection
  - ✓ Flanged end rating PN6 / 10 / 16 / 20 / 40..., 150 Lbs, 300 Lbs, 600 Lbs, 900 Lbs, 1500 Lbs, 2500 Lbs etc... (RF, RTJ)
  - ✓ Buttweld, socket weld or threaded ends
  - ✓ Groovelok type ends
  - ✓ Etc...

## ▶ Valves

- **Gate Valves**
  - ✓ Wedge type
  - ✓ Penstock / Sluice type
  - ✓ Through conduit type
- **Globe Valves**
  - ✓ Piston type
  - ✓ Ball type
  - ✓ Swivel disc type
- **Check Valves**
  - ✓ Swing type
  - ✓ Axial flow / Nozzle type
  - ✓ Wafer type
  - ✓ Spring return type
- **Ball Valves**
  - ✓ Floating type
  - ✓ Trunnion Mounted type
  - ✓ Metal seated type
  - ✓ Top Entry
- **Plug Valves**
  - ✓ Standard design
  - ✓ Lubricated type
- **Butterfly valves**
  - ✓ Concentric rubber lined
  - ✓ Double/Triple offset metal to metal tight shut off type
  - ✓ Through conduit type
- **Choke Valves**
  - ✓ Axia flow control type
  - ✓ Angle body control type
- **Double Block & Bleed Valves**
  - ✓ Ball valve design
  - ✓ Butterfly valve design
  - ✓ Twin seal plug valve design
- **Control Valves**
- **Pressure Reducing Valves**
- **Safety Relief Valves**
- **Strainers**
  - ✓ Y Type
  - ✓ T Type
  - ✓ Bucket type
- **Diaphragm Valves**
- **PFA/PTFE Lined valves**
- **Valve Locking Devices**



## ➤ Mechanical & Electronic devices for the measurement of:

- **Pressure**

- ✓ Switches (gauge or differential types)
- ✓ Gauges (tube, capsule, diaphragm, differential types)
- ✓ Sensors / Transducers
- ✓ Transmitters (fixed range or smart and configurable type)
- ✓ Diaphragm / Tubular Seals
- ✓ Pressure limiters, Dampeners, Siphons, Cocks & Valves

- **Temperature**

- ✓ RTD Sensing elements (probes, sensors...)
- ✓ Infrared pyrometers
- ✓ Bimetallic thermometers
- ✓ Gas filled thermometers
- ✓ Mechanical switches
- ✓ Accessories



## ► Mechanical & Electronic devices for the measurement of:

- **Level**
  - ✓ Potentiometric level measurement
  - ✓ Level switches / sensors for hygienic application
  - ✓ Magnetic or Glass level gauges
  - ✓ Magnetostrictive level transmitters
  - ✓ Guided wave radar transmitters
  - ✓ Laser transmitters
  - ✓ Ultrasonic transmitters & switches
  - ✓ Vibrating level switches
  - ✓ Thermal dispersion level switches
- **Flow**
  - ✓ Transmitters
  - ✓ Switches
  - ✓ Meters

## Instrumentation

- **Test & Calibration**
  - ✓ Precision pressure gauges
  - ✓ Tube manometers
  - ✓ Pressure generators
  - ✓ Portable pressure calibrators
  - ✓ Portable calibrating systems
  - ✓ Dead-weight tester
  - ✓ Dry block portable calibrators
  - ✓ Portable / Non portable temperature bathes
  - ✓ Reference temperature probes
- **Inductive Conductivity Transmitters**
- **Humidifier**
- **Control Cabinets**
- **Solenoid Valves**
  - ✓ Direct acting type
  - ✓ Pilot operated poppet type
  - ✓ Diaphragm operated
  - ✓ Namur solenoid vales
  - ✓ Redundant operation

## ► Actuators

- Electric on multi & part turn applications, including ON / OFF, APT (Analog Position Transmitter) & Proportional (from 4 - 20 mA output signal)
- Pneumatic (DA or SR) on part turn applications, including ON / OFF, APT (Analog Position Transmitter) & Proportional (from 4 - 20 mA output signal)
- Hydraulic on multi & part turn applications
- Gas on part turn applications





## Steam & Hot Water Engineering division

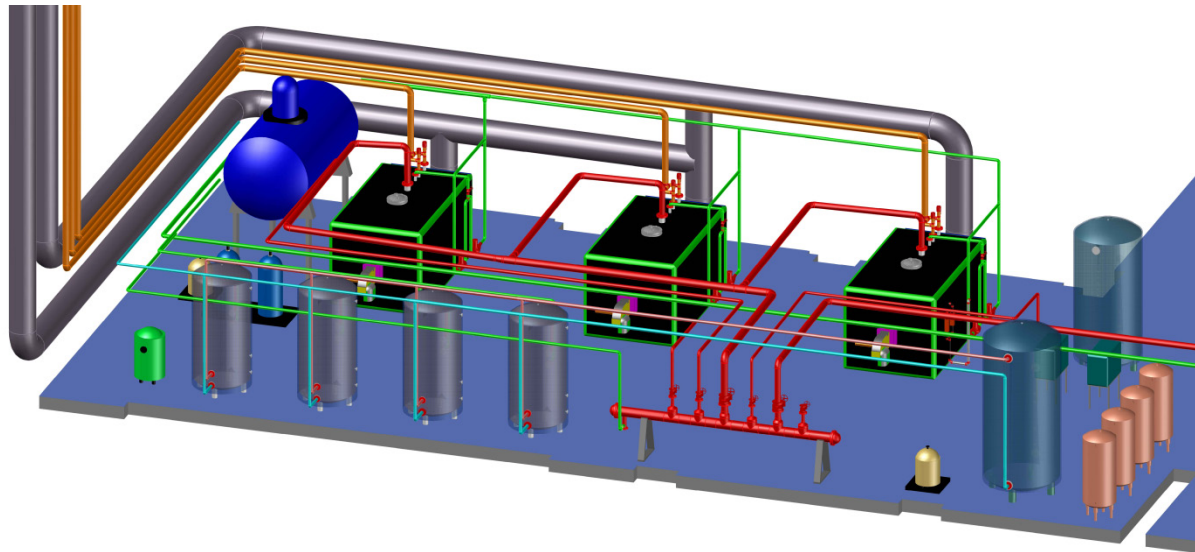

## ► Steam products

- **Steam Traps**
  - ✓ 3 year warranty Inverted bucket type
  - ✓ Float & Thermostatic type
  - ✓ Control disc type
  - ✓ Bimetallic
  - ✓ Thermostatic wafer type
  - ✓ Thermostatic bellow type
  - ✓ Fully equipped Trap Valve Station (TVS)
- **Steam Tracing Equipment**
  - ✓ Double sealed valves
  - ✓ Manifold for steam distribution
  - ✓ Manifold for condensate collection



## ► Steam products

- **Condensate Recovery Equipment**
  - ✓ Mechanical pumping trap and packages
  - ✓ Flash recovery vessels
  - ✓ Stainless steel sump ejectors
- **Pressure & Temperature Control**
  - ✓ Pressure Reducing Valves
  - ✓ Cyclone separators
  - ✓ Temperature regulators
  - ✓ Control valves
  - ✓ Steam Traps
- **Steam Tracing Equipment**
  - ✓ Double sealed valves
  - ✓ Manifold for steam distribution
  - ✓ Manifold for condensate collection
- **Water Heating**
  - ✓ Instantaneous water heaters
  - ✓ Shell & tube heat exchangers
  - ✓ Clean in Place scale removal system
- **Strainer (see valves)**
- **Air Vents**
- **Liquid Drainers**

## ► Hot water products

- **Hot Water Boilers**
  - ✓ Conventional hot water boilers
  - ✓ High efficient condensing boilers
  - ✓ Electric calorifiers
- **Steam Boilers**
  - ✓ Three pass reverse, wet back
  - ✓ Genuine 3 pass
  - ✓ Electrical steam boilers
  - ✓ Clean steam generators
- **Calorifiers**
  - ✓ Steel, glass lines or sinterflon lined
  - ✓ Stainless steel
- **Heat Exchangers**
  - ✓ Plate heat exchangers
  - ✓ Shell & tube heat exchangers
- **Solar Systems**
  - ✓ Flat solar panels
  - ✓ Heat pipe collectors
  - ✓ Thermosyphon
- **Heat Pumps**
  - ✓ Water to water
  - ✓ Air to water
- **Additional Equipment**
  - ✓ Chimneys
  - ✓ Softeners
  - ✓ Chemical dosing
  - ✓ Pressurization units
- **Control panels**
  - ✓ Master control panels
  - ✓ All protocols
  - ✓ Remote control features





## 5 Services

## ► Stock

- 5 stocks in the world, included 4 in the Gulf region
- 45,000 tons of pipes and valves stock
- Full range of services
- Close to your projects and to strategic access points of the region



## ► Yards & Services

- 5 Logistic platforms
- Steam Survey & Energy Audit
- Valve automation
- Valve Interlocking
- Valve Maintenance
- Repair and Testing
- Pipe Finishing
- Machining
- Testing



## ► Project Solutions

- Technical Consulting
- Sourcing & Procurement
- Product Preparation
- Testing & Pre-commissioning
- Project Management
- Customer stock management services and logistics



## ► Jebel Ali - UAE

- 30,000 Sqm area
- Stock of valves and actuators in sizes from ½" to 36"
- Valve Automation Center: 400 m<sup>2</sup>
- Sand blasting area
- Warehousing



## ► Doha - Qatar

- 20,000 Sqm area
- Stock of valves and actuators in sizes from ½" to 36"
- Stock of ductile Iron pipes
- Stocks of valves and accessories for water network
- Valve Automation Center: 152 m<sup>2</sup>
- Warehousing
- 5 pipe wrapping machines



## ► Jubail - Saudi Arabia

- 30,000 Sqm area
- Stock of valves and actuators in sizes from ½" to 36"
- Valve actuation services
- Warehousing



## ► North of Rumaila - Iraq

- 60,000 Sqm area
- Piping storage area up to 100,000 tons
- Project material management
- Warehousing

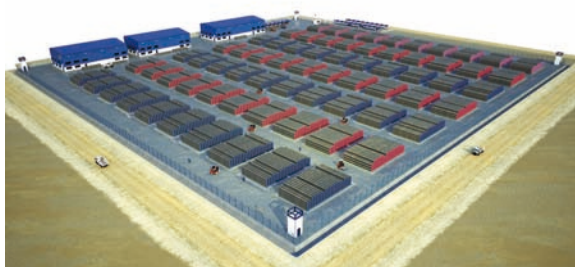

## ► Port Klang - Malaysia

- 10,000 Sqm area
- Stock of plates for offshore application
- Structural tubular seamless and welded
- Warehousing





## ► Head office

### **TROUVAY & CAUVIN Holding Group B.S.C. (c)**

JAFZA Tower - View 18 – 27th floor  
P.O. Box 16954, Jebel Ali Free Zone  
Dubai, United Arab Emirates  
Tel: + 971 (0) 4 8835848  
Fax: + 971 (0) 4 8835997  
E-mail: info@trouvaycauin.com

## ► Asia Pacific

### **TROUVAY & CAUVIN Asia Pacific Co, Ltd**

Exchange Tower, 34th Floor, Unit # 3404-1,  
388 Sukhumvit Road, Klongtoey,  
Bangkok 10110 – Thailand  
Tel: + 66 (0) 2 6725 250  
Fax: + 66 (0) 2 6725 255  
Email: info.apac@trouvaycauin.com

### **TROUVAY & CAUVIN Korea**

Room 1507 – Korea Business Center 1338-21  
Seocho- Dong Seocho Gu  
Seoul - Korea  
Tel: + 82 (0) 2 765 9934  
Fax: + 82 (0) 2 179 9933  
Email: info.seoul@trouvaycauin.com

### **TROUVAY & CAUVIN China**

A039 F12, China Overseas Plaza  
No8 Guuanghai Doongli  
Chao Yang District - China  
Tel: +86 (0) 10 59892073  
Fax: + +86 (0) 10 59892074  
Email: info.beijing@trouvaycauin.com

## ► Europe

### **TROUVAY & CAUVIN Ltd**

Broughton House - Broadgate  
Broadway Business Park  
Chadderton, Oldham – Lancs OL9 9XA  
United Kingdom  
Tel: + 44 (0) 1 61 6847488  
Fax : + 44 (0) 1 61 6847487  
Email: sales@trouvay-cauin.co.uk

## ► United States

### **TROUVAY & CAUVIN USA**

#### **T&C Piping USA LLC**

Granite Towers at Sugar Creek Phase II  
13131 Dairy Ashford – Suite 105  
Sugar Land, TX 77478 - USA  
Tel: + 1 281 565 4400  
Fax : + 1 281 565 4401  
Email: info.houston@trouvaycauin.com

## ► India

### **TROUVAY & CAUVIN India**

31 Rani Jhansi Road  
New Dheli – 110 055 - India  
Tel: + 91 (0) 11 2367 8537  
Fax : +91 (0) 11 2367 9648  
Email: info.newdheli@trouvaycauin.com

## ► Middle East

### **TROUVAY & CAUVIN Gulf B.S.C. (c)**

Jebel Ali Branch  
P.O. Box 16954, Jebel Ali Free Zone  
Dubai, United Arab Emirate  
Tel: + 971 (0) 4 8835848  
Fax: + 971 (0) 4 8835997  
E-mail: info@trouvaycauin.com

### **TROUVAY & CAUVIN Gulf B.S.C. (c)**

c/o TC Equipment Establishment  
P.O. Box 37120, Dubai  
United Arab Emirates  
Tel: + 971 (0) 4 8835848  
Fax: + 971 (0) 4 8835997  
Email: info.dubai@trouvaycauin.com

### **TROUVAY & CAUVIN Engineering Supply LLC**

P.O. Box 2016, Abu Dhabi  
United Arab Emirates  
Tel: + 971 (0) 2 6271496  
Fax: + 971 (0) 2 6275410  
Email: info.abudhabi@trouvaycauin.com

### **TROUVAY & CAUVIN Gulf B.S.C. (c)**

c/o Pan Arabian Office Co.Ltd.  
P.O. Box 4119, Al Khobar 31952,  
Kingdom of Saudi Arabia  
Tel: + 966 (0) 3 8821115  
Fax: + 966 (0) 3 8829609  
Email: info.dammam@trouvaycauin.com

### **TROUVAY & CAUVIN Gulf B.S.C. (c)**

c/o Pan Arabian Office Co.Ltd.  
P.O. Box 36388  
Jubail Industrial City, 31961  
Kingdom of Saudi Arabia  
Tel: + 966 (0) 3 3400888  
Fax: + 966 (0) 3 3400999  
Email: info.jubail@trouvaycauin.com

### **TROUVAY & CAUVIN Gulf B.S.C. (c)**

c/o Pan Arabian Office Co.Ltd.  
P.O. Box 907 Riyadh 11421  
Kingdom of Saudi Arabia  
Tel: + 966 (0) 1 2030653  
Fax: + 966 (0) 1 2030652  
Email:  
info.riyadh@trouvaycauin.com

### **TROUVAY & CAUVIN Gulf B.S.C. (c)**

c/o Pan Arabian Office Co.Ltd.  
P.O. Box 727 – Jeddah 21421  
Kingdom of Saudi Arabia  
Tel: + 966 (0) 2 6518580  
Fax: + 966 (0) 2 6516636  
Email: info.jeddah@trouvaycauin.com

### **TROUVAY & CAUVIN Gulf B.S.C. (c)**

c/o Ahmad Aluthman & Bros W.L.L.  
P.O. Box 2117, Doha  
State of Qatar  
Tel: + 974 4 4342402  
Fax: + 974 4 4982273  
Email: info.doha@trouvaycauin.com

### **TROUVAY & CAUVIN Gulf B.S.C. (c)**

c/o Salman Enterprises Trading  
P.O. Box 54418, Manama,  
Kingdom of Bahrain  
Tel: + 973 (0) 1 7744711  
Fax: + 973 (0) 1 7744733  
Email: info.manama@trouvaycauin.com